



Meadows
Edge
at Clark-Lindsey

CONTRACT OPTIONS



The Trails

Bedrooms	2
Baths	2
Garage	2-car +
Kitchen	Open floor plan Stainless steel appliances
Fireplace	Included
Washer/Dryer	Included
Total SF	Gross: 1,662 / Net: 1,565 (Does not include garage)
Garage Gross SF	621
Options	Den Screened patio Sunroom Several finish packages



The Monarch

Bedrooms	2
Baths	2
Garage	1-car
Kitchen	Open floor plan Stainless steel appliances
Fireplace	Included
Washer/Dryer	Included
Den Alcove	Included
Total Gross SF	Gross: 1,751 / Net: 1,639 (Does not include garage)
Garage Gross SF	389
Options	Basement (1,776 gross sf) Screened patio Sunroom Several finish packages Elevator



The Parkview

Bedrooms	2
Baths	2.5
Garage	2-car
Kitchen	Open floor plan Stainless steel appliances
Fireplace	Included
Washer/Dryer	Included
Den	Included
Lower Level	Finished or Unfinished
Total SF	Gross: 4,185 / Net: 4,042 (Does not include garage)
1st Floor SF	Gross: 2,082 / Net: 1,939
Lower Level SF	2,103
Garage SF	Gross: 586 / Net: 548
Options	Den Screened porch Sunroom Several finish packages

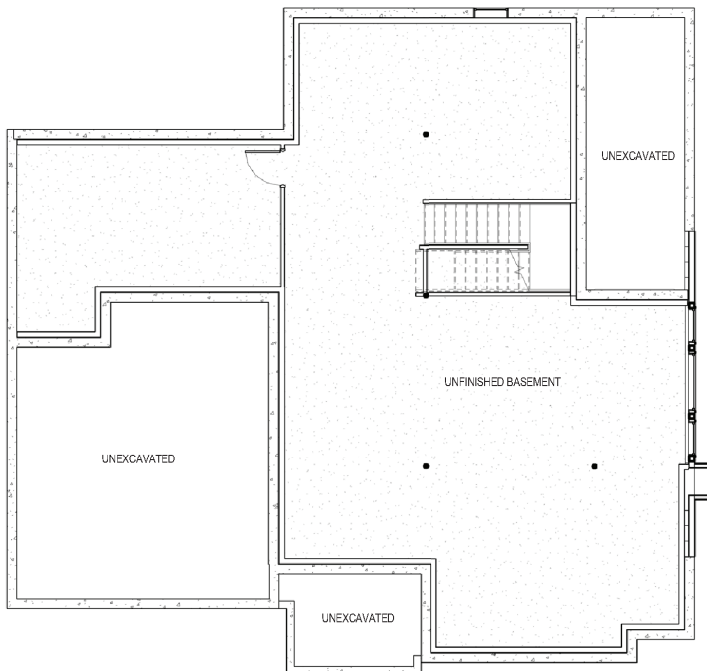

Lower Level Unfinished



Lower Level Finished

Meadows Edge at Clark-Lindsey **Residency Contract Options**

Traditional Contract Plan

This contract includes all of the lifestyle features and amenities available, plus priority access to all levels of care. If the last occupant relinquishes their unit prior to 60 months of occupancy, a pro-rata refund is available (80% at the end of year one; 60% at the end of year two; 40% at the end of year three; 20% at the end of year four).

75% Refundable Contract Plan

This contract includes all of the lifestyle features and amenities available, plus priority access to all levels of care. Under this contract, residents are guaranteed a minimum refund of 75% of entrance fees, no matter how long they reside in their unit.

The refundable contract is only available to individuals who are 85 years of age or younger. As a couple, eligibility is based off the younger of the two.

Note: Under the traditional contract, the pro-rata refund is payable upon death, withdrawal or permanent transfer of the last surviving occupant to Meadowbrook Health Center or the Green House Homes. Under the 75% refundable contract option, the refund is payable after the last survivor leaves Clark-Lindsey, Meadowbrook Health Center or the Green House Homes, and the unit is re-sold and re-occupied. Under this option, in cases of benevolence, the refundable portion would first be used before Friendship Fund assistance is available.

Trails Villa

Traditional Contract: **\$343,000-\$366,000** | Refundable Contract 75%: **\$497,000-\$537,000**

Monthly Service Fee: **\$3,430**

Monarch Villa

Traditional Contract: **\$284,000-\$427,000** | Refundable Contract 75%: **\$427,000-\$586,000**

Monthly Service Fee: **\$3,250**

Parkview Villa

Traditional Contract: **\$481,000-\$570,000** | Refundable Contract 75%: **\$663,000-\$797,000**

Monthly Service Fee: **\$3,900**



101 West Windsor Road | Urbana, Illinois 61802
(217) 344-2144 | www.clark-lindsey.com | retire@clark-lindsey.com

